

User Guide

Quick start for 4G Camera

V 1.0

Install the App

Please use your web browser scan the following QR code, download and install it onto your smartphone/tablet.

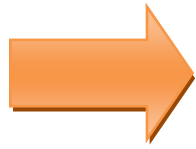

Android



iOS

Login

■ If you DO NOT have a registered account

Step 1 Open the App. Tap **Register Account**.

Step 2 Choose the region where you are. Then enter your email address.

Step 3 Tap **GET VERIFICATION**. (Tips: If you do not receive activation code. 1. Please check your spam box. 2. Check if you enter the correct email address. 3. Enter another email address.)

Step 4 Enter the **Verification Code**. Set the login password, and tap **REGISTER**.

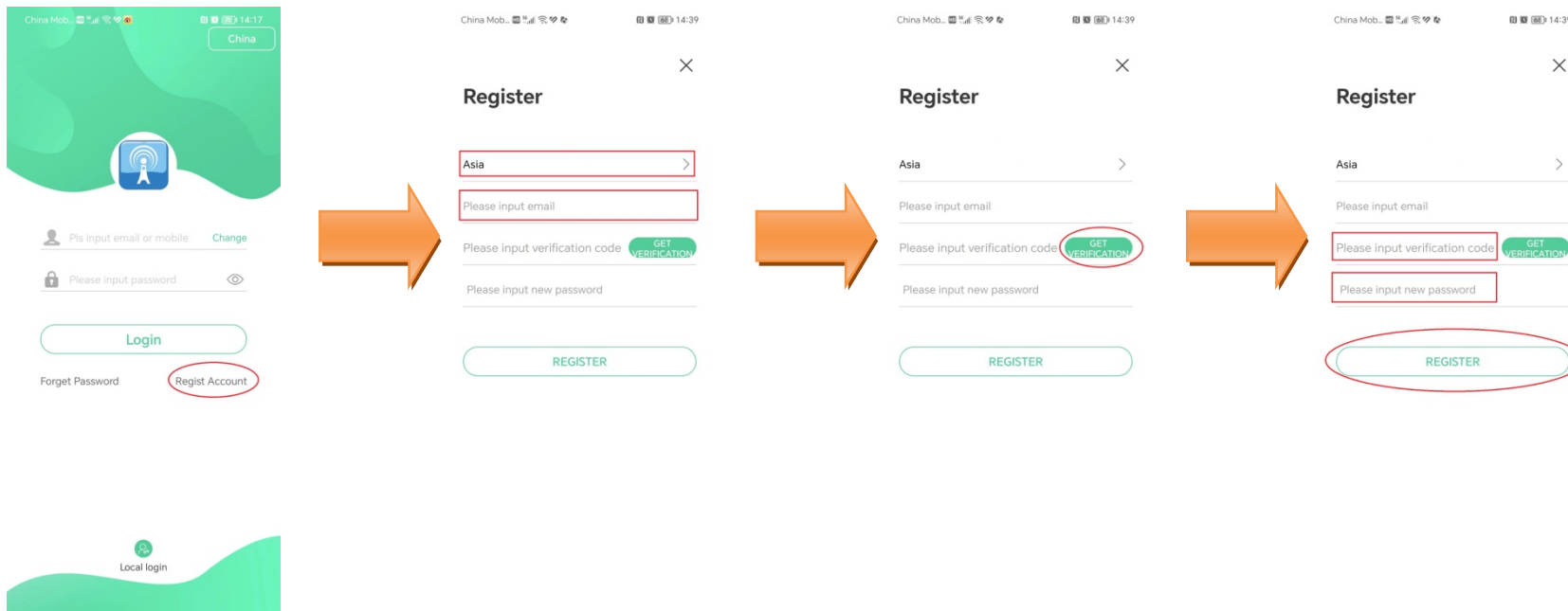

■ **If you already have a registered account**

Step 1 Open the App.

Step 2 Enter the registered Email address and password, and tap **Login**.

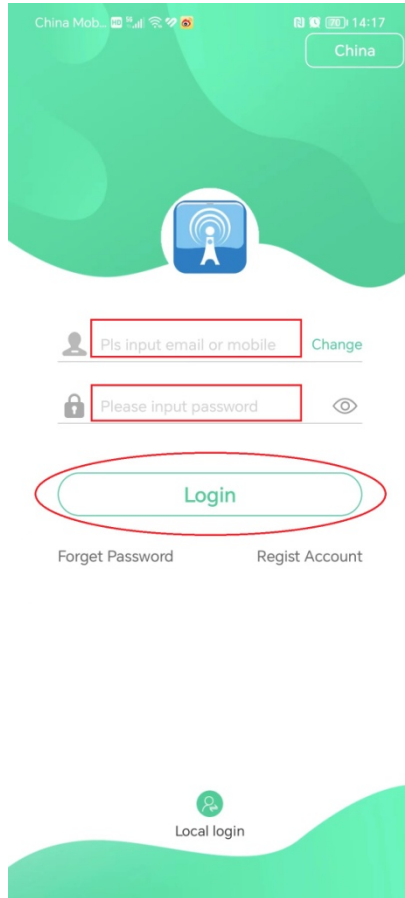

Add the 4G camera to App

Step 1 Please confirm with your carrier if this 4G SIM Card use any one of these bands.

4G Band		
LTE-FDD	LTE-FDD B1	✓
	LTE-FDD B3	✓
	LTE-FDD B5	✓
	LTE-FDD B8	✓
LTE-TDD	LTE-TDD B34	✓
	LTE-TDD B38	✓
	LTE-TDD B39	✓
	LTE-TDD B40	✓
	LTE-TDD B41	✓

Step 2 Login app and insert 4G SIM Card.

Step 3 Add the 4G camera to App.

- 1 At the App home page, tap **Add device** or **+** in the upper right corner of the home page.
- 2 Tap **4G access to the network**.
- 3 Power on the camera and tap **Next**.
- 4 Tap **Next**.
- 5 Tap **OK**.
- 6 Tap **Scan ID and add device**.
- 7 Scan the QR code on the device.
- 8 Check the UID and tap **OK**.
- 9 Add equipment successfully.

Tips: If your 4G SIM Card not use anyone of these bands, you will not see the video.

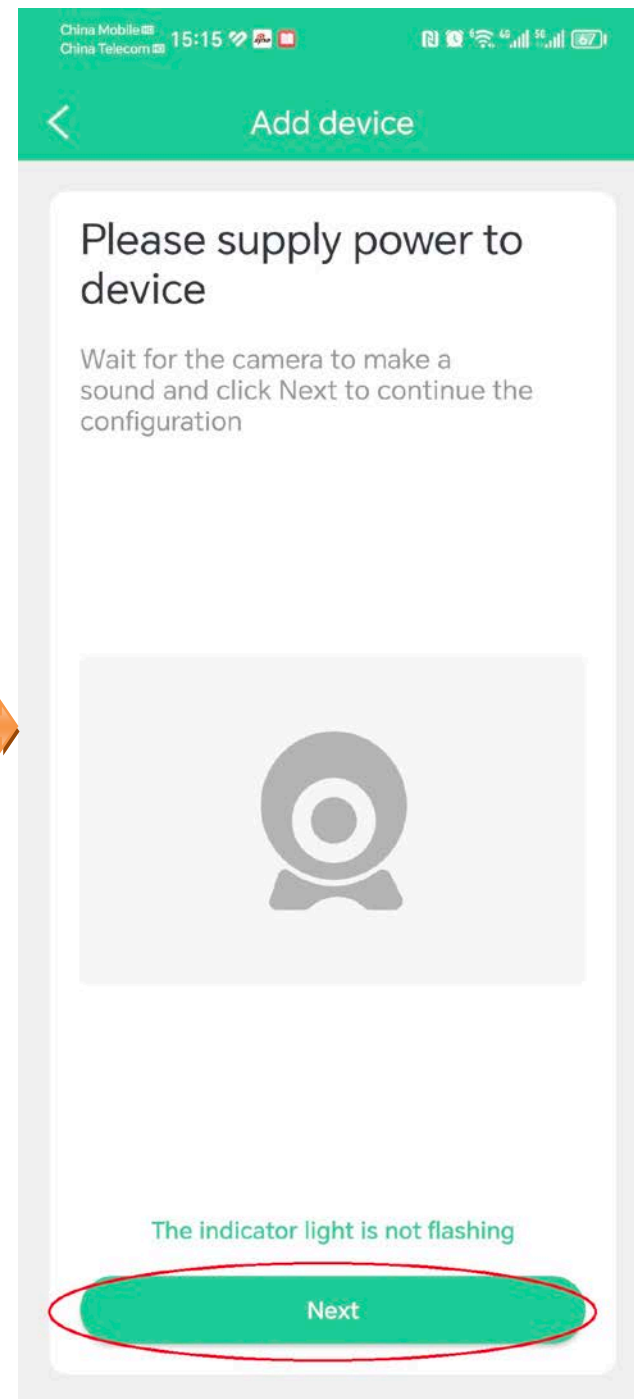
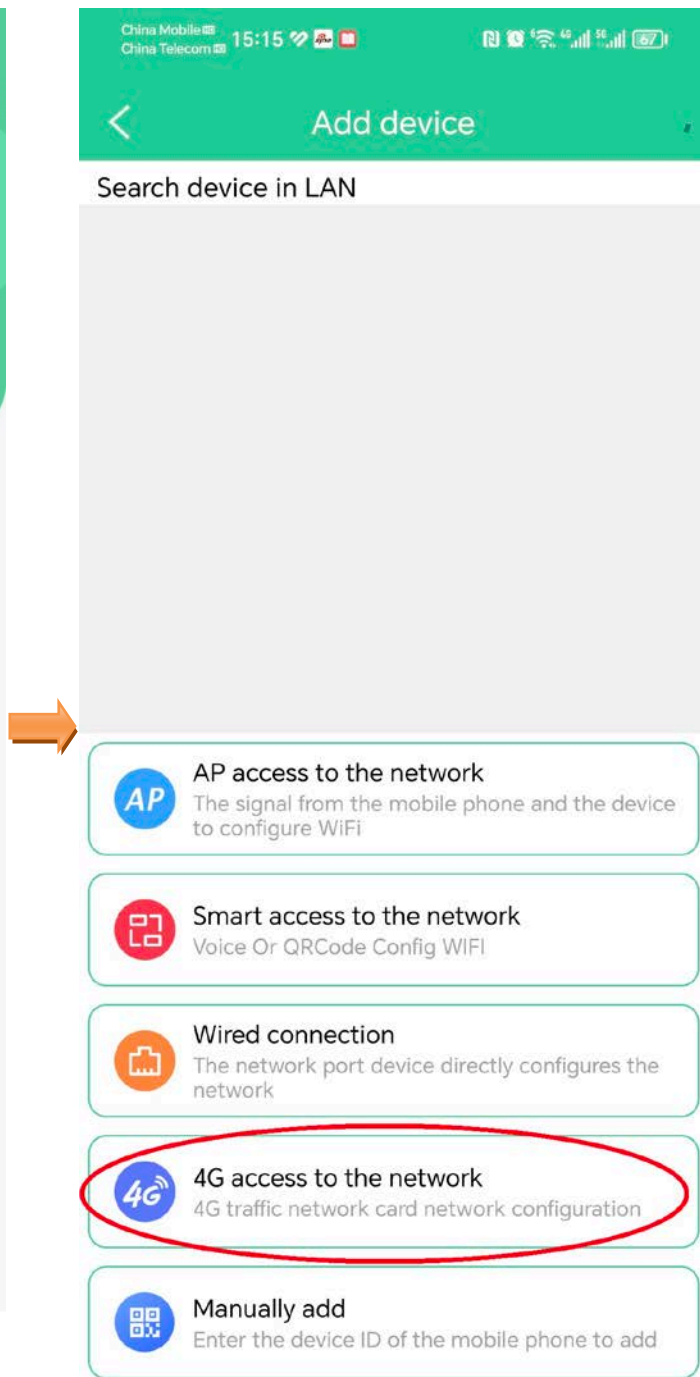
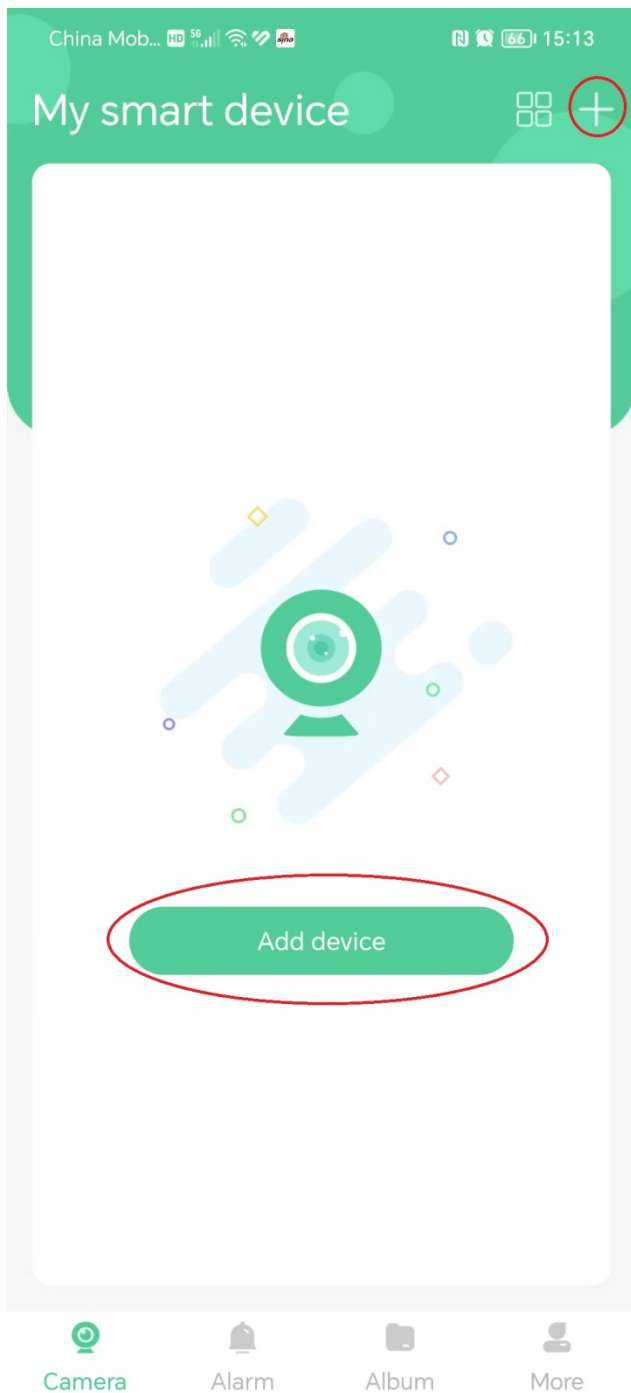

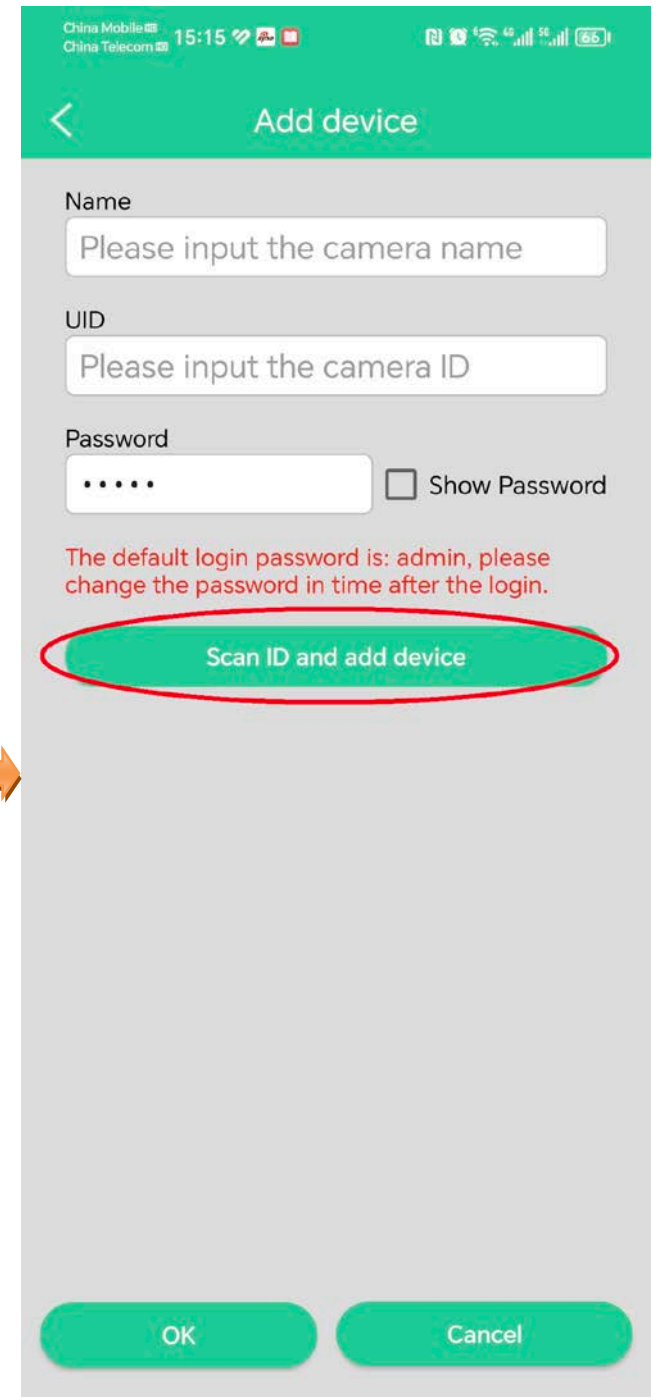
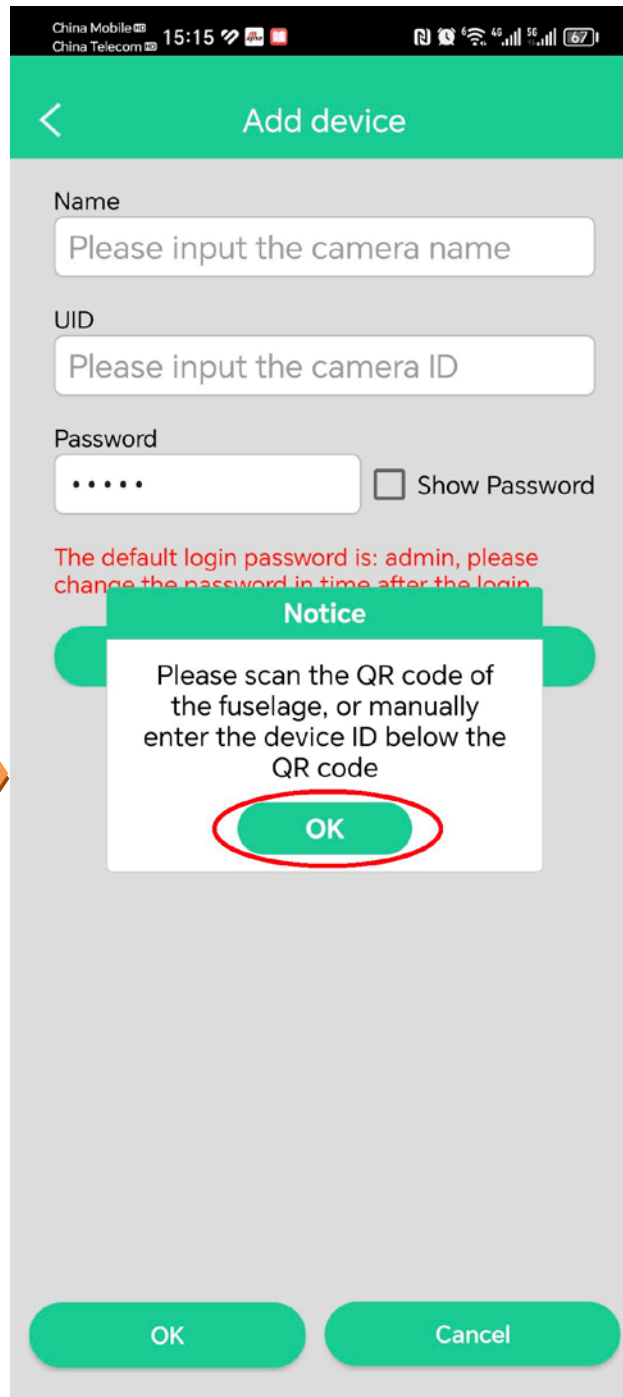

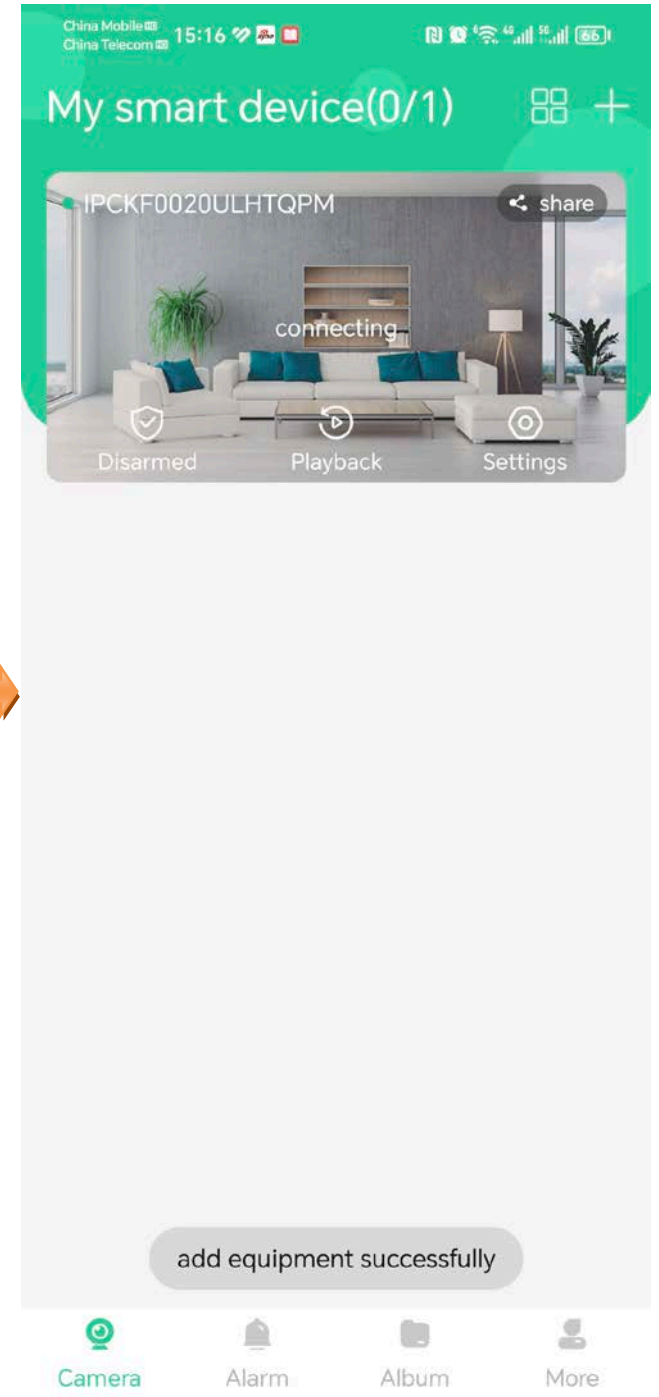
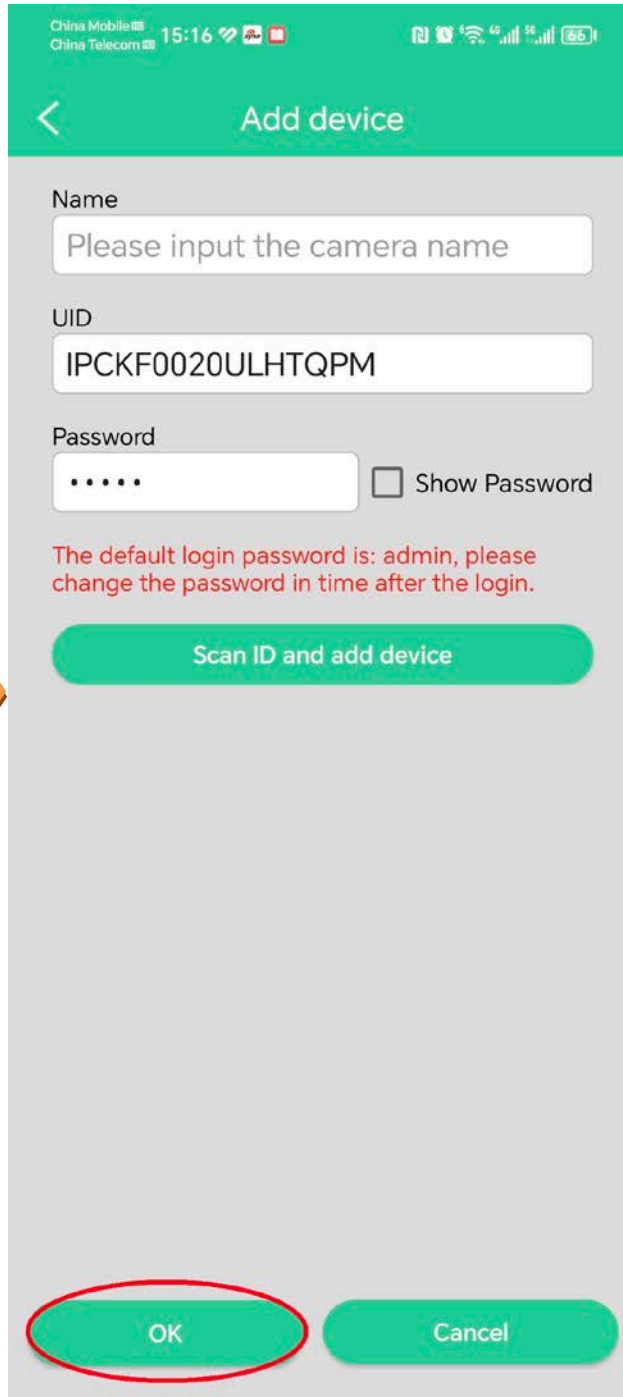

Home page

After logging in to App, the default page is **Home** page. You can preview all devices under this account, or add a device, etc.

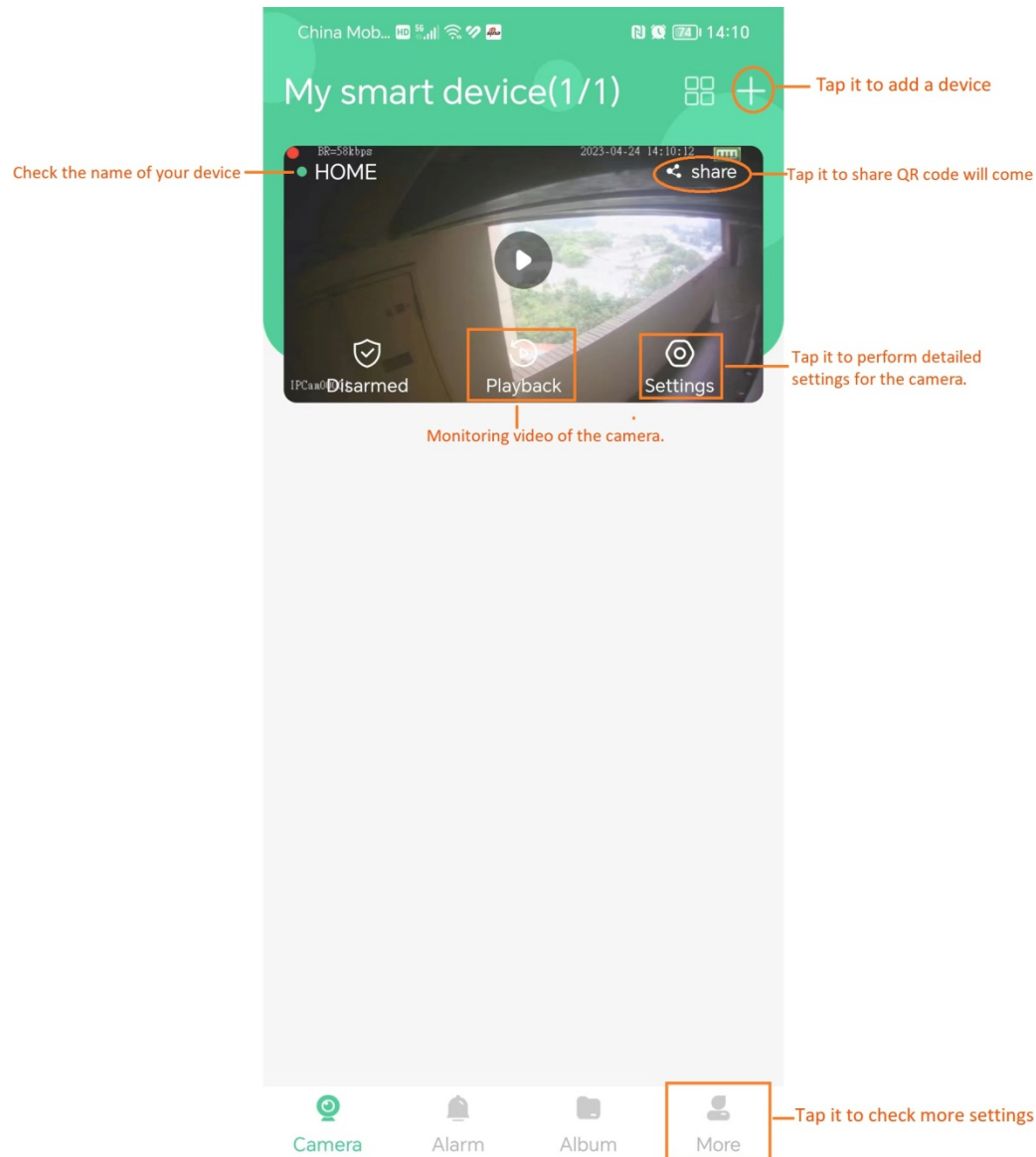

Micro SD card recording storage

Use Micro SD card for the first time

Camera supports recording storage in Micro SD card. After the camera successfully identifies the Micro SD card, it will automatically start recording according to the recording mode.

Step 1 Log in to App to check whether the Micro SD card can be identified normally.

1. Log in to App. Tap the camera **Settings** which you want to set on the homepage.
2. Tap **Record Settings**.
3. View the **SD status**.

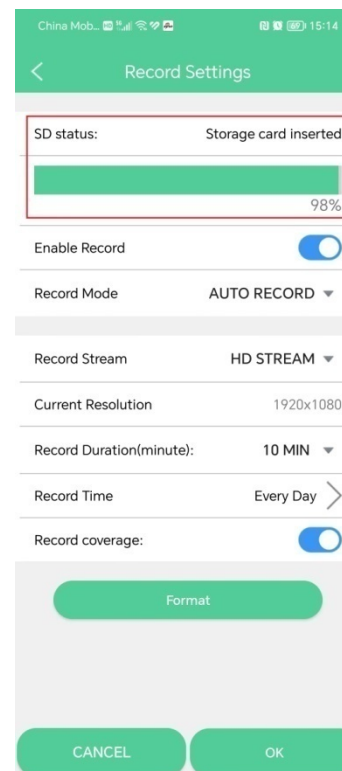
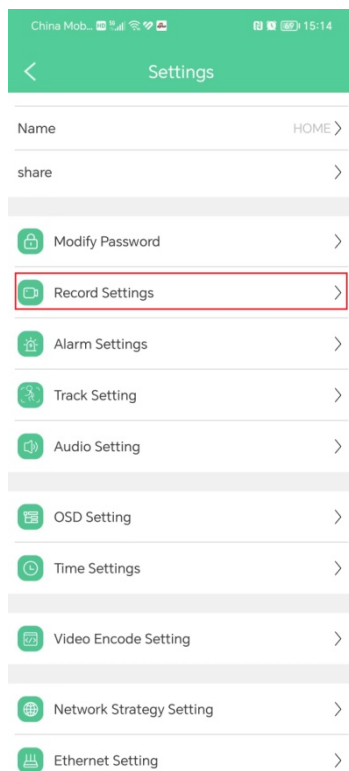
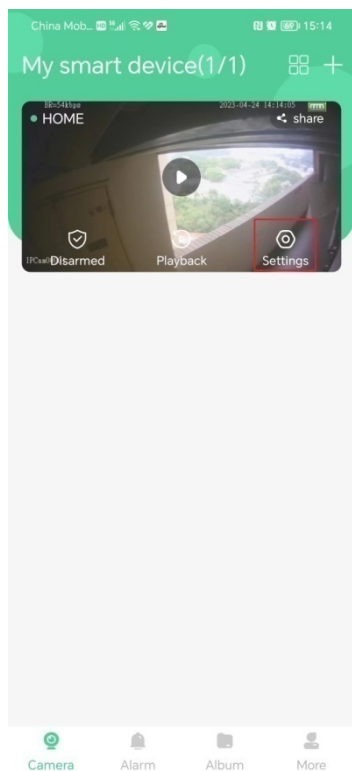

Step 2 Format the Micro SD Card.

If necessary tap **Format** button to format.

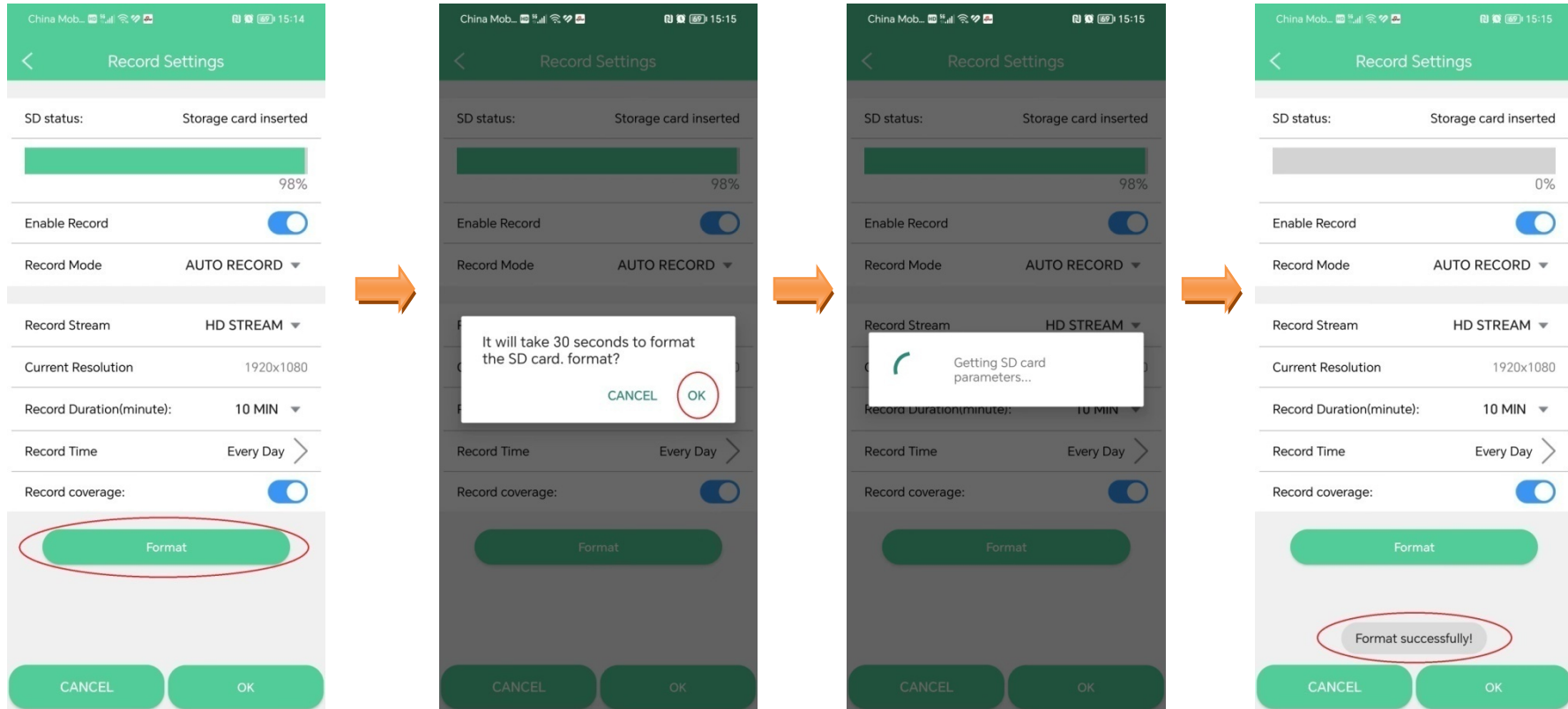

Attention: All the information will be deleted after format.

View videos on the smartphone

Method 1

Log in to App, Tap the camera **Playback** which you want to view on the homepage > Drag time pointer.

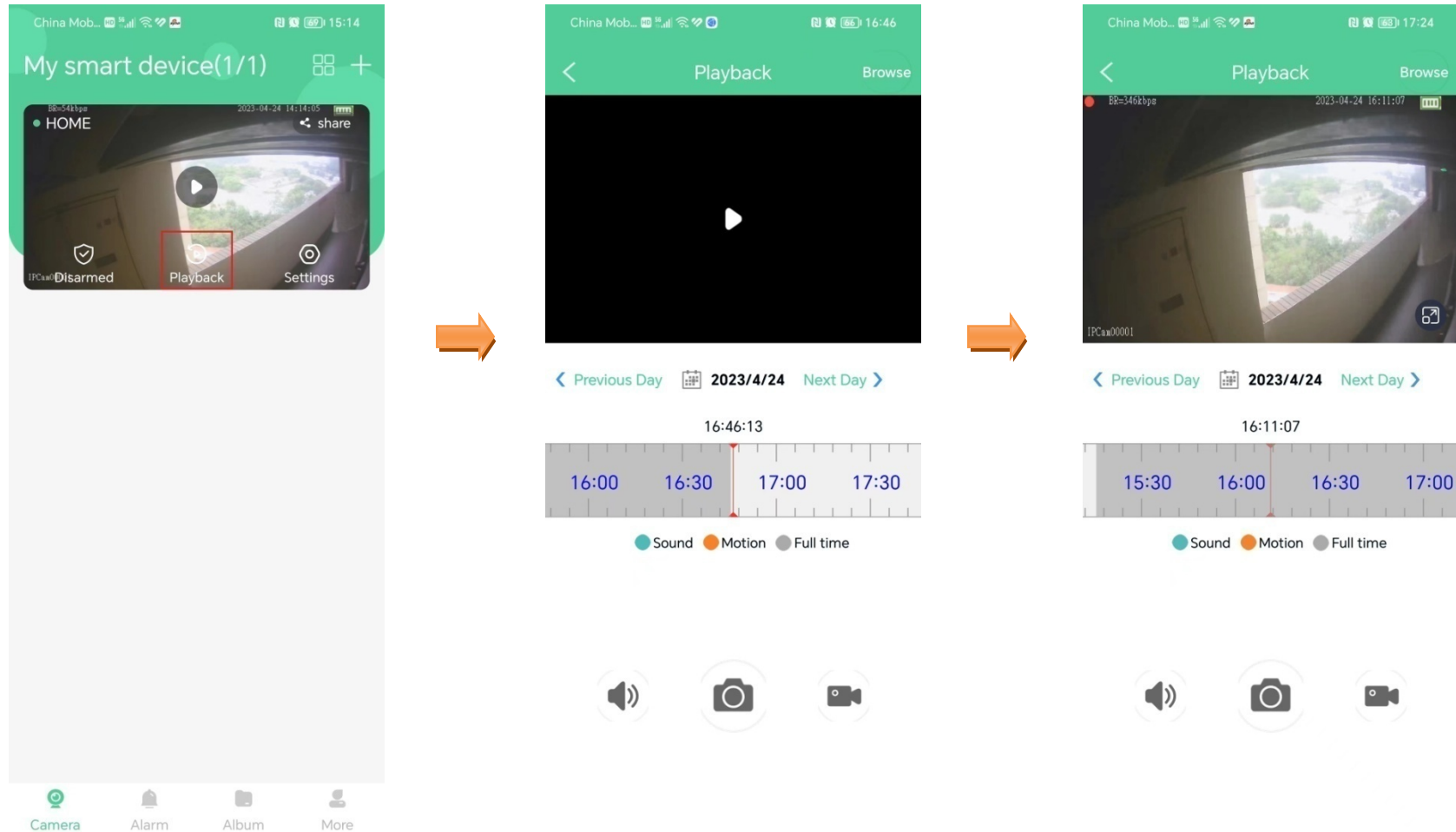

Method 2

Log in to App, Tap the camera **Playback** which you want to view on the homepage > **Browse** > choose the videos you need > **Play**.

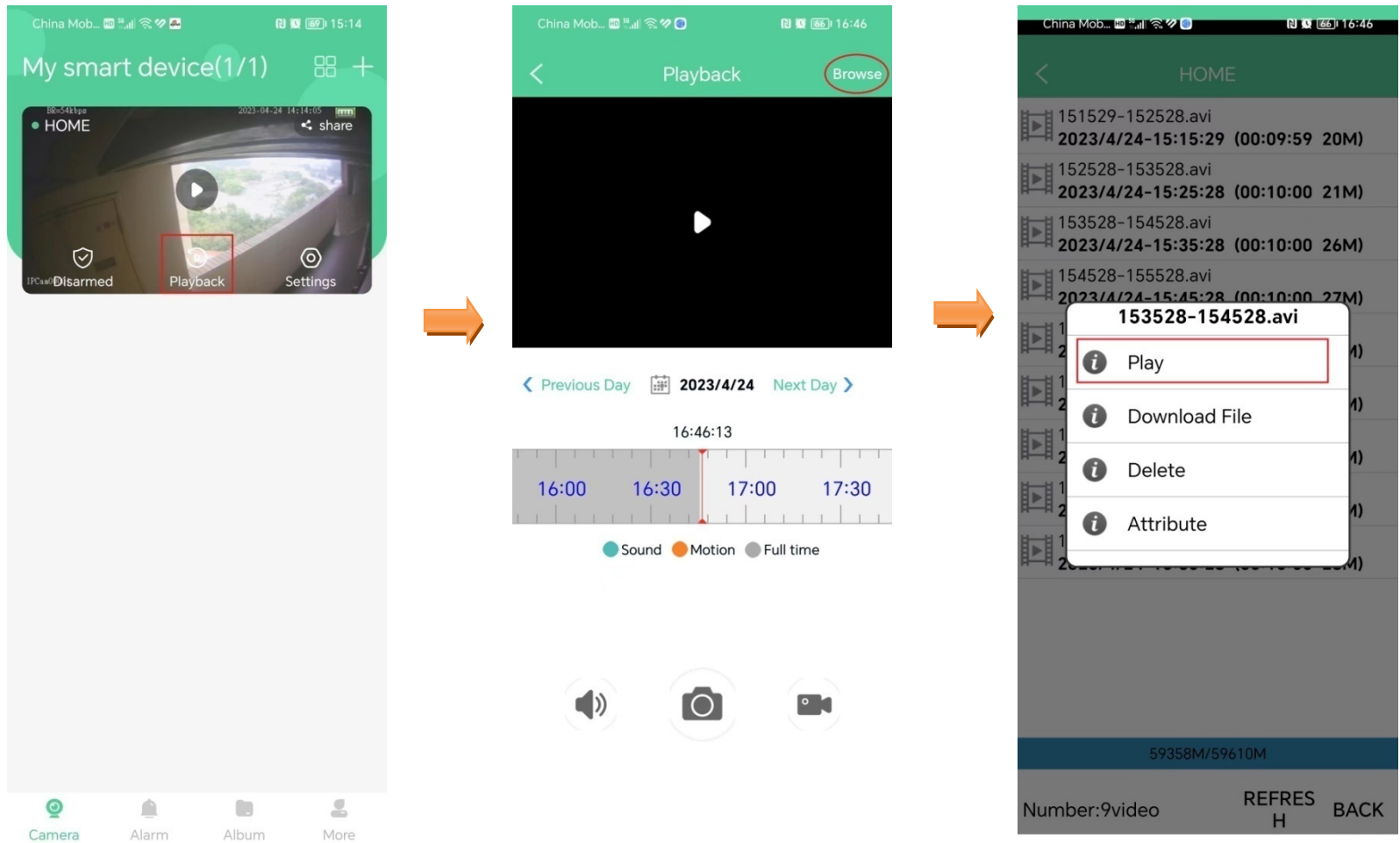

Download videos to the smartphone

Log in to App, Tap the camera **Playback** which you want on the homepage > **Browse** > choose the videos you need > **Download File**. Wait Download completed.

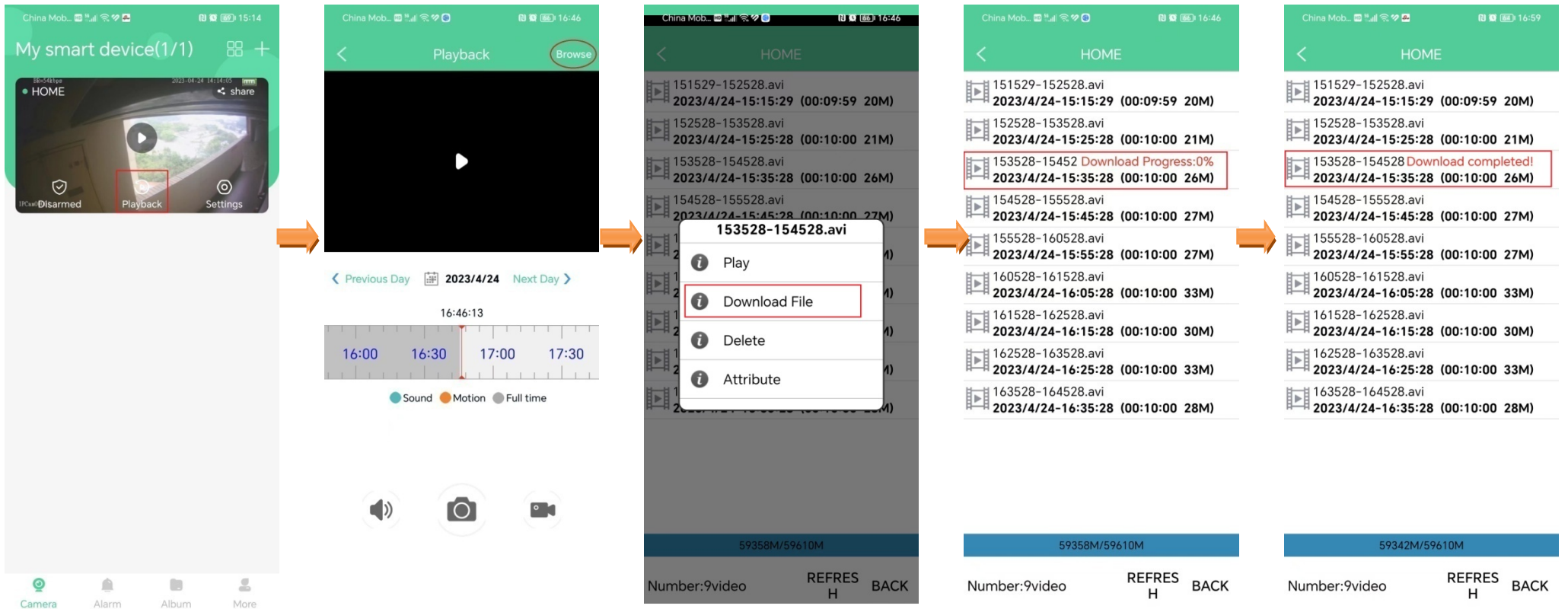

View the download videos

Log in to App, Tap **Album** > tap ▾ and choose the camera > tap **Download**.

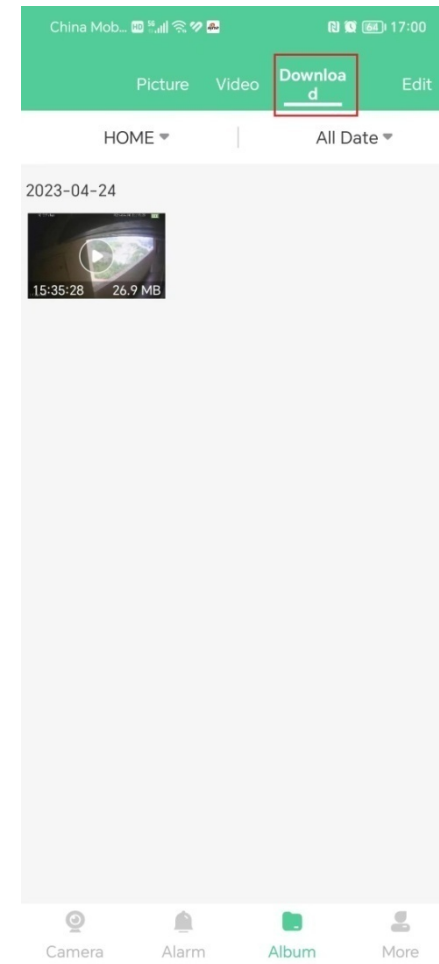
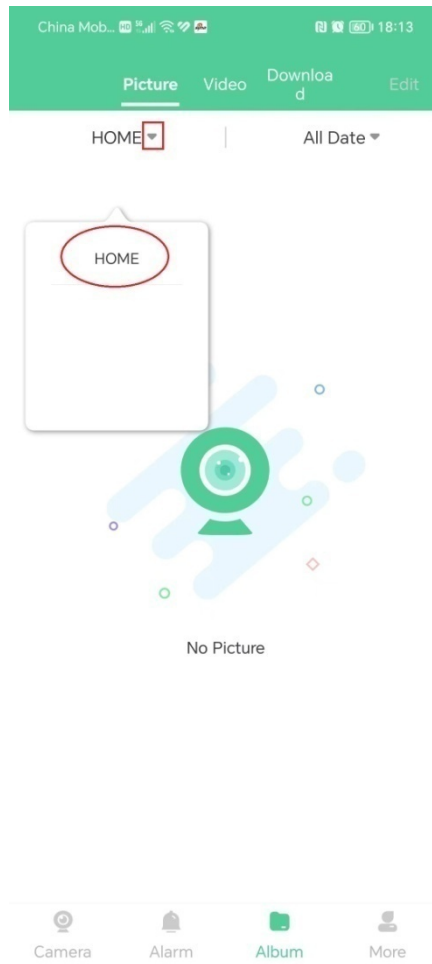
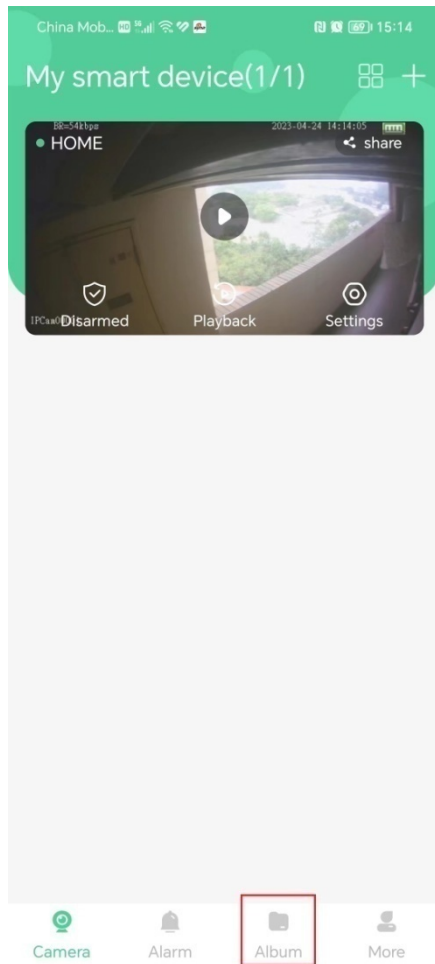

Reboot the camera

Log in to App, Tap the camera **Settings** which you want reboot on the homepage > **Reboot the camera** > tap **OK**. Wait the camera reboot.

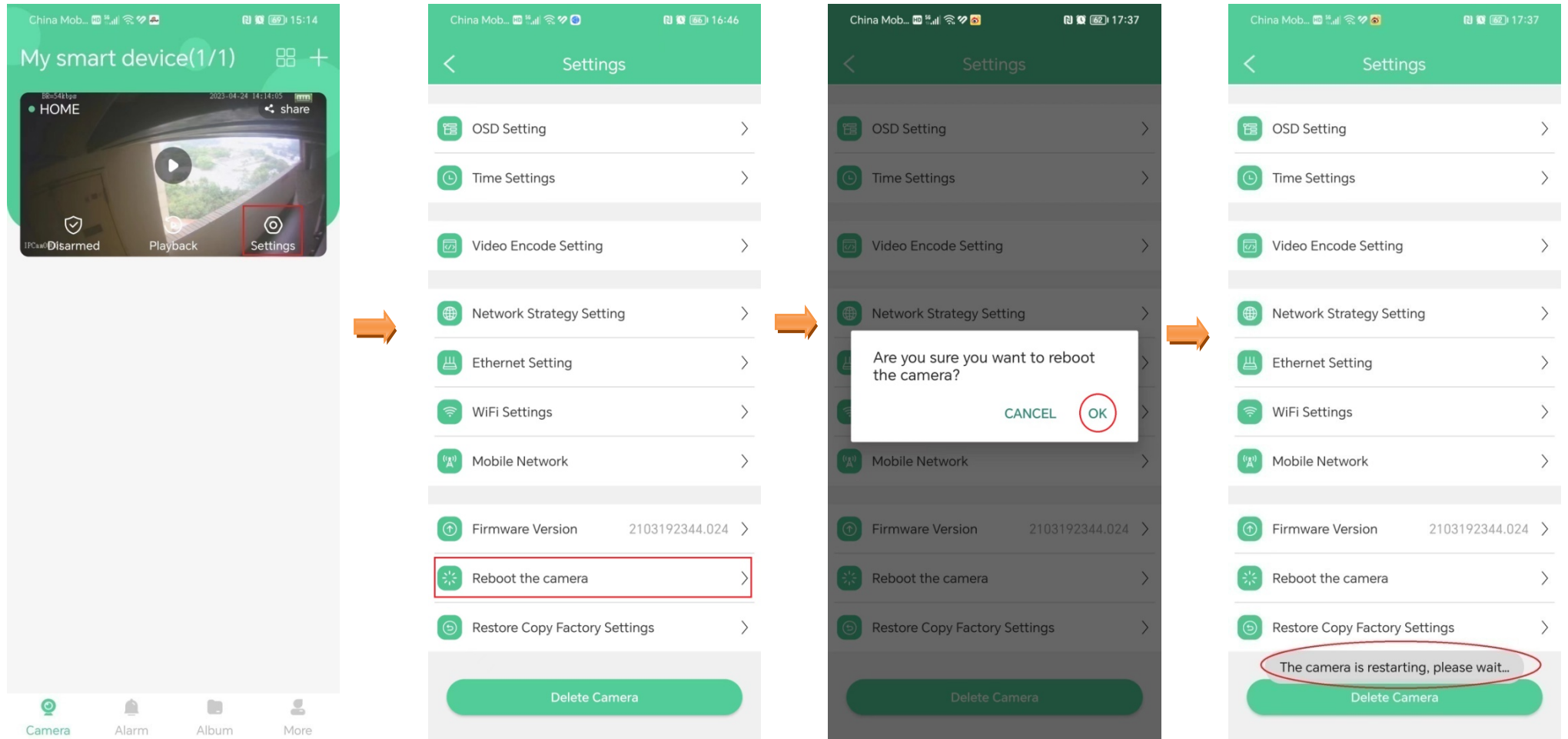

Restore factory settings

Log in to App, Tap the camera **Settings** which you want restore on the homepage > **Restore Copy Factory Settings** > tap **OK**. Wait the camera reset to default.

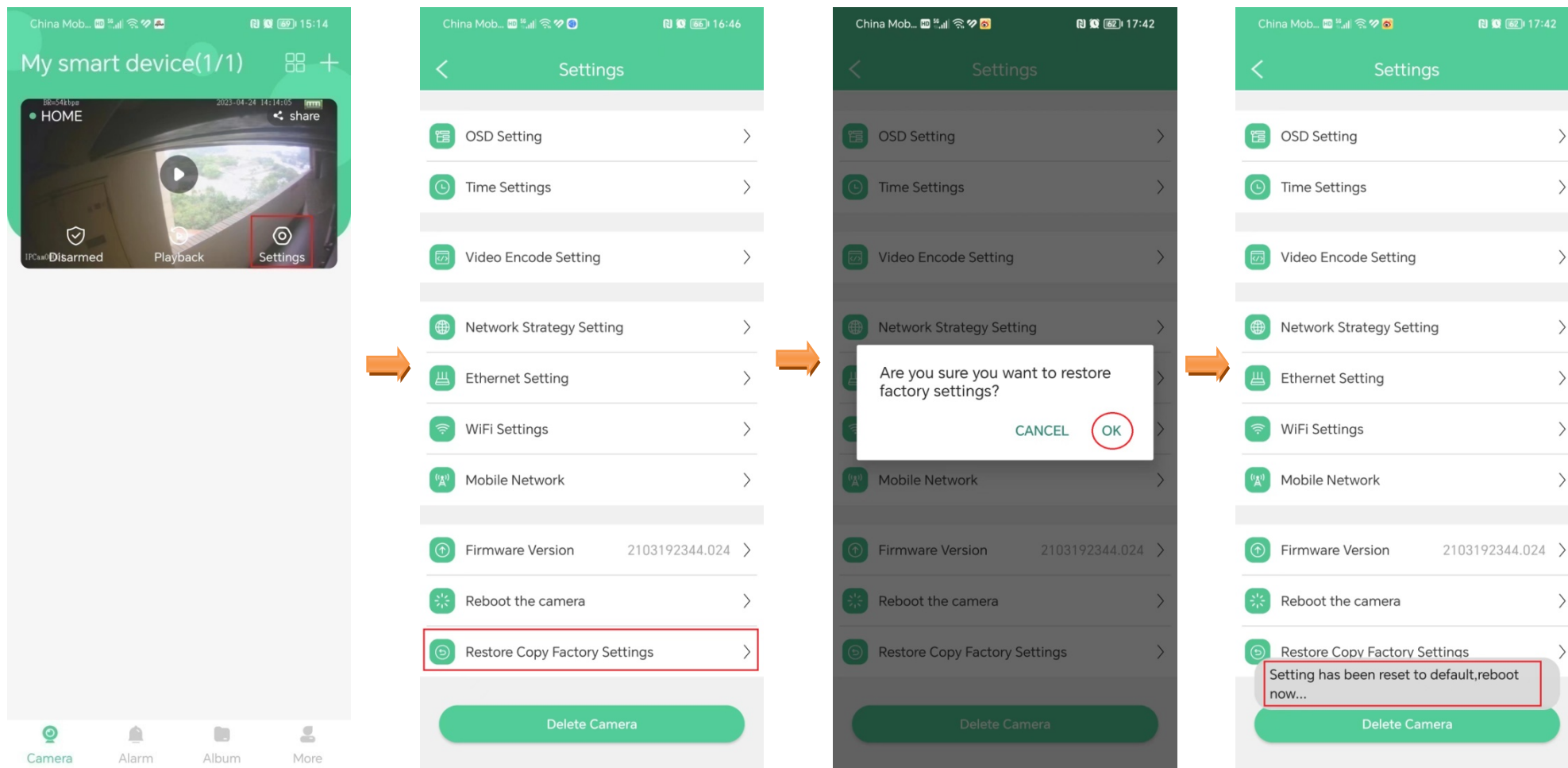

Attention: All the binding to the Wi-Fi routers will be deleted after restore.